

HORIZONTAL TANK TYPE COMPRESSOR directly mounted on SLR Restrained Spring Mounts. Reinforced housekeeping pad secured by HPA Anchors.

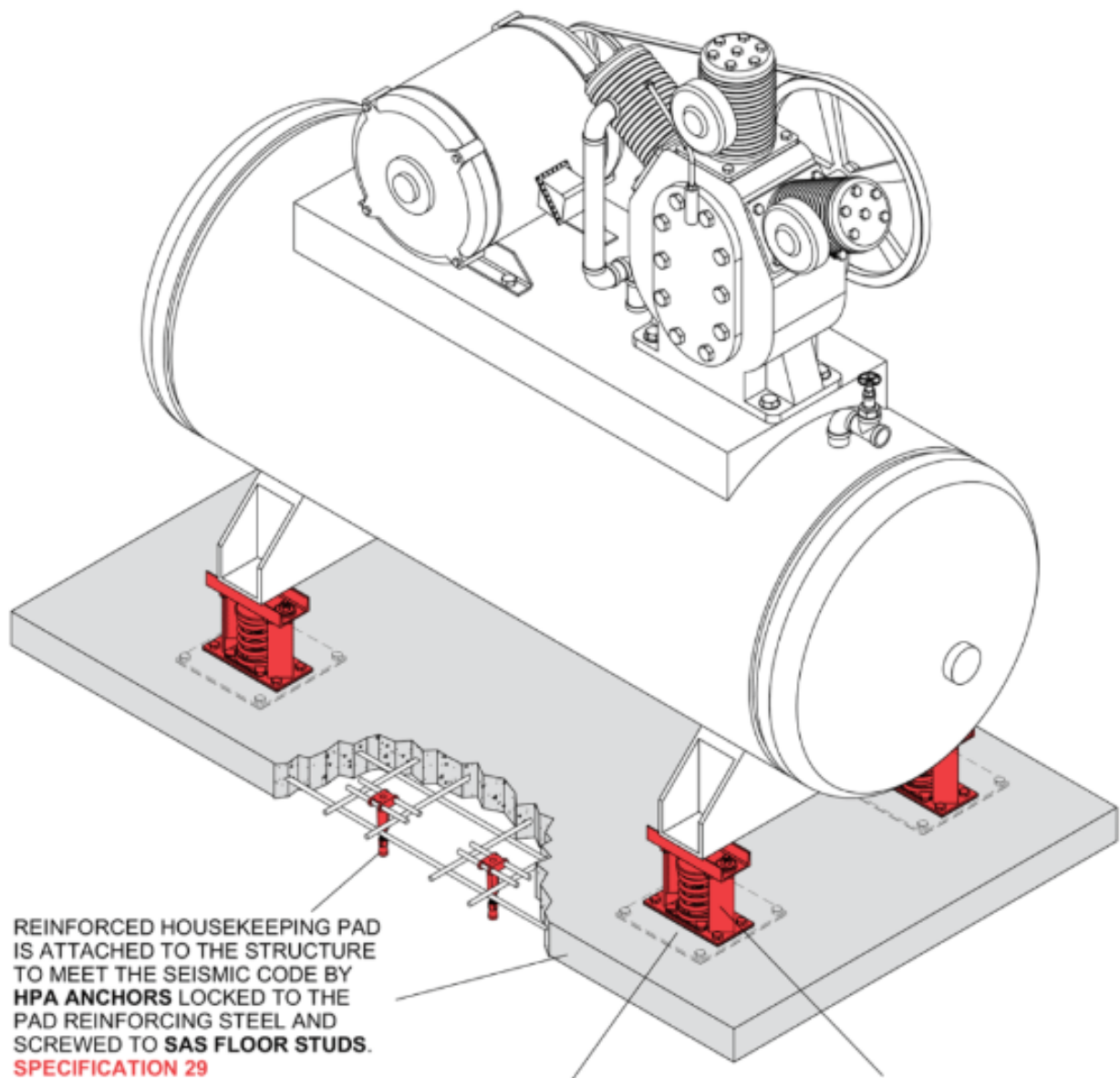

REINFORCED HOUSEKEEPING PAD IS ATTACHED TO THE STRUCTURE TO MEET THE SEISMIC CODE BY **HPA ANCHORS** LOCKED TO THE PAD REINFORCING STEEL AND SCREWED TO **SAS FLOOR STUDS**.
SPECIFICATION 29

IN SEISMIC ZONES EXTENDED BASE PLATES MAYBE REQUIRED TO MEET BOLTING CODES AND MUST BE ANCHORED WITH **SAB ANCHORS**.
SPECIFICATION 19

SLR RESTRAINED SPRING MOUNT WITH SPECIFIED FREQUENCY. MUST BE SECURED WITH **SAB ANCHORS**
SPECIFICATION 9

RECIPROCATING DIRECT DRIVE COMPRESSOR with height saving brackets on high deflection SLF Mounts and Z-1011 Seismic Restraints. Reinforced housekeeping pad secured by HPA Anchors.

SLF SPRING MOUNTS
WITH SPECIFIED DEFLECTION
SPECIFICATION 5

HEIGHT SAVING
BRACKET

FRICTION PAD
BOLTING NOT
REQUIRED

COMPRESSOR MANUFACTURERS
BASE MUST HAVE SUFFICIENT
INTEGRITY TO ACCEPT MOUNTING
AND SNUBBER LOADING

RECIPROCATING DIRECT DRIVE COMPRESSOR

HOUSEKEEPING PAD
IS ATTACHED TO THE STRUCTURE
TO MEET THE SEISMIC CODE BY
HPA ANCHORS LOCKED TO THE
PAD REINFORCING STEEL AND
SCREWED TO **SAS FLOOR STUDS**.
SPECIFICATION 29

RESILIENT Z-1011
SEISMIC SNUBBERS
MUST BE SECURED
WITH **SAB ANCHORS**
SPECIFICATION 17

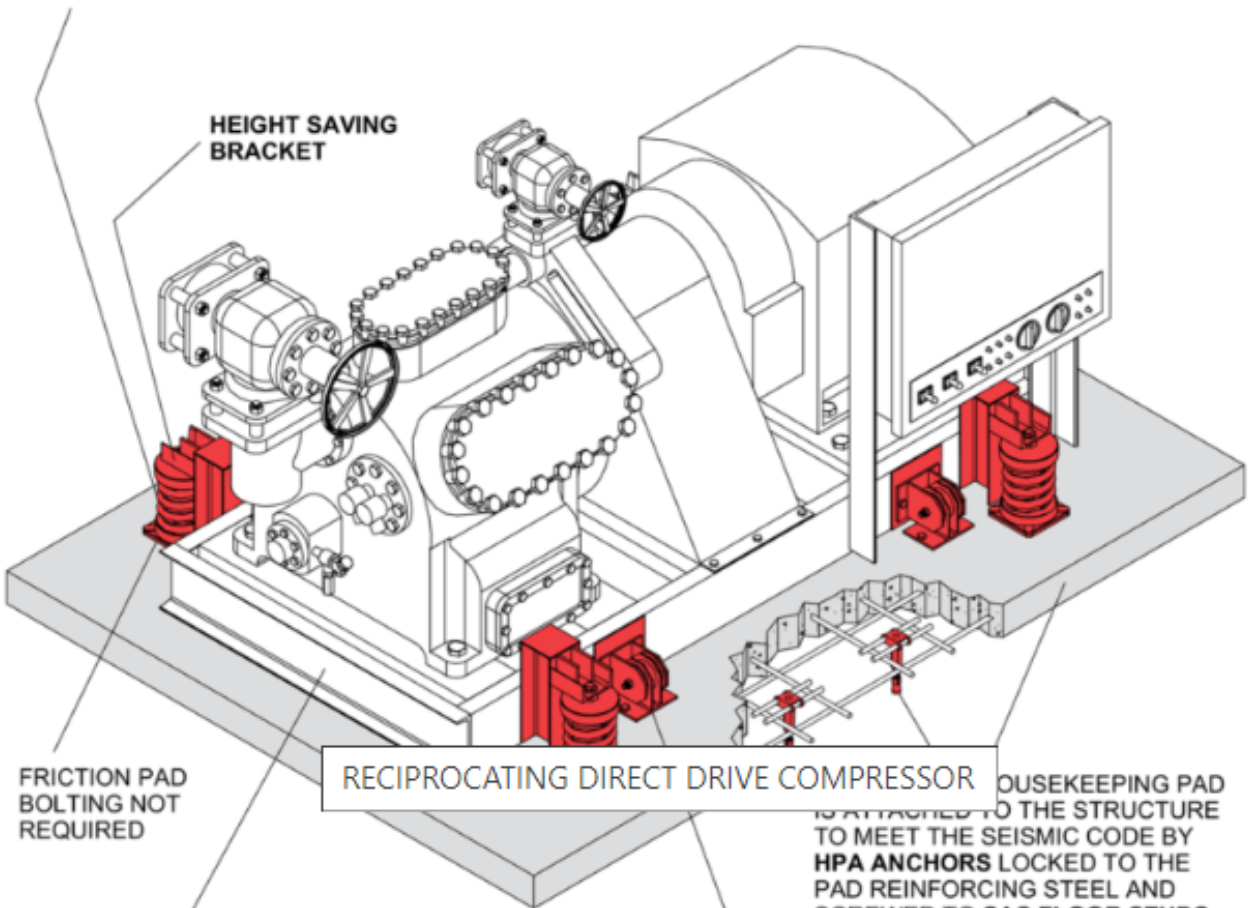

VERTICAL TANK TYPE COMPRESSOR directly mounted on BMK Concrete Filled Base, 1" deflection SLF Mounts and Z-1011 Seismic Restraints. Reinforced housekeeping pad secured by HPA Anchors.

